



Connect to Wi-Fi Network



Automatic Day/Night Viewing



Sound/Motion Detection:
Trigger email alerts



View more with Pan & Tilt Function



Remote Viewing: View on iPhone®,
iPad®, Android® or Windows® phone
with mydlink™ app



microSD card slot: record directly
to microSD³

HD Pan & Tilt Day/Night Network Camera

Cloud Camera

Product Highlights

Pan & Tilt

View more and cover wider areas of your home

Easy to install anywhere

Built in Wireless N and a 10/100 Ethernet
port for flexible and flawless connection throughout your

home

Night Vision

Built-in IR LEDs to monitor your home even in complete darkness

microSD card slot

Allows you to record video directly onto the camera and view
at a later time

DCS-5222L

Overview

View more, do more, protect more with the clarity and mobile control of D-Link's DCS-5222L surveillance solution. Download the free mydlink app and monitor your home or business – anywhere, anytime – on your smartphone or tablet. Experience confident clarity and total control with the DCS-5222L 720p HD recording and ultra-smooth pan/tilt and digital zoom functionality. Integrated motion-sensing and night-vision technology provide round-the-clock surveillance when you're most vulnerable, and with easy installation you'll have an effective, affordable home or business surveillance solution up and running in no time. Experience the peace of mind D-Link provides with DCS-5222L.



mydlink™ Lite - mobile app designed for
iOS, Android and Windows Phone devices

mydlink™+ - mobile app designed for iOS
and Android tablets

Features

- HD 1280x720p resolution @ 30 FPS
- Supports H.264/M-JPEG video codecs
- Built-in LEDs for viewing in dark environments
- 10x digital zoom for close-up viewing
- Wireless 802.11n compliant⁷ with Wi-Fi Protected Setup (WPS) button
- 2-way audio (built-in mic and speaker)
- Built-In PIR sensor for enhanced motion detection
- microSD card slot for local recording³
- Motion detection to trigger recording and send e-mail/push alerts
- App support for iPhone, iPad, Android, and Windows Phone
- mydlink Portal for easy viewing and management
- Administrator/User password protection
- UPnP support for network setup & configuration
- Pan/Tilt allows for optimal positioning of the camera, controllable via the mydlink app or mydlink Portal
- Zero Configuration with D-Link Cloud routers⁴

Package Contents

- DCS-5222L camera
- External power adapter
- CAT5 Ethernet cable
- Quick Installation Guide
- Remote control
- Installation CD
- Camera base and mounting kit

Minimum System Requirements

Wired (10/100 Fast Ethernet) or Wireless (802.11g or 802.11n) Network (Wireless N network recommended for optimum wireless performance)

Computer with:

- 128MB Memory
- Windows[®] 7⁵, Windows 8[®] 5 and Windows[®] XP SP2[®] 5, or Mac OS X6 (10.5 and above, Intel Processor)
- Internet Explorer[®] v6, Mozilla[®] Firefox[®] v3.0, Google[®] Chrome v2, or Safari[®] v4
- CD-ROM Drive

For Internet Access:

- Cable or DSL Modem
- Subscription with an Internet Service Provider (ISP)

Power Supply:

- 110~240VAC, 50/60Hz

720p HD for Superior Image Quality

The D-Link HD Pan & Tilt Day/Night Network Camera delivers the confidence of 720p HD video clarity, ensuring rich detail and crisp image quality for your surveillance recording. And with integrated night-vision and PIR motion-sensing technology, the DCS-2330L remains vigilant 24 hours a day, whether you're there or not.

Industry-Leading Remote Viewing with mydlink™

With the free mydlink™ mobile app, you can monitor your home or business on your iPhone, iPad, Android device or Windows® phone and experience the peace of mind that comes from having round-the-clock surveillance at your fingertips. Check in on your home while you're at work, or monitor your business when you're out of the office – with mydlink, you can keep an eye on what matters, whenever and wherever you want.

Make Easy Setup Even Easier – With Zero Configuration⁴

Connecting your D-Link camera with any router is easy – make it even easier with your D-Link Cloud Router. Zero Configuration automatically configures and intelligently syncs your D-Link camera to your mydlink account – it's as easy as connect and view!

Record Directly to microSD Card³

The camera features a microSD card slot for hassle-free recording and playback. No additional PC, network video recorder, or other device is needed. Enjoy the easy and efficient alternative for recording and storing video.

Easy 3-Step Installation

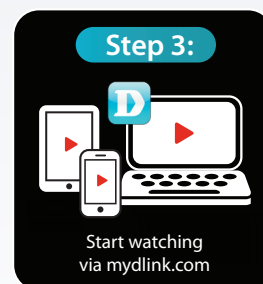
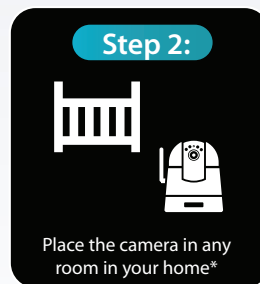
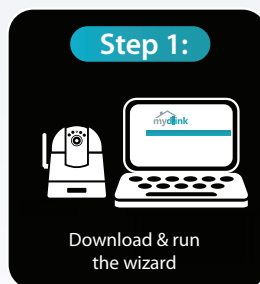

*Connection to home network required

H.264 Advantage⁶

Superior video quality to MPEG-4 with significantly lower bitrate (approximately 50% lower than MPEG-4 and 80% lower than M-JPEG).

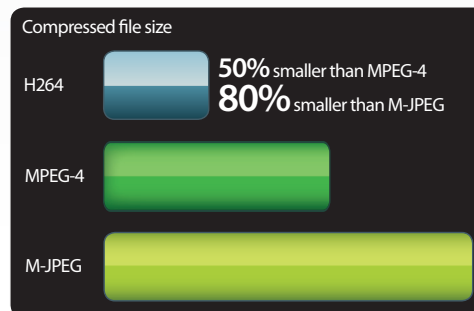

DCS-5222L Outdoor HD Wireless Network Camera

Technical Specifications

Camera Specifications

- 1/4" Megapixel Progressive CMOS sensor
- 8 meter IR illumination distance
- Minimum illumination 0 Lux with IR LED on
- Built-in Infrared-Cut Removable (ICR) Filter module
- Built-in Passive Infra-Red (PIR)
- Fixed length 4.57 mm
- Aperture F1.9
- Field of view:
 - (H) 45.7°
 - (V) 29.5°
 - (D) 52.9°
- Built-in Microphone/Speaker⁴

Video Features

- Configurable image size, quality, frame rate, and bit rate
- Time stamp and text overlays
- Configurable motion detection windows
- Configurable shutter speed, brightness, saturation, contrast, mirror, flip
- Three configurable privacy mask zones

Video Compression

- JPEG for still images
- H.264/MJPEG format simultaneous compression
- H.264 multicast streaming

Resolutions

- 16:9 (support frame rate up to 30 fps)
- 1280 x 720
- 640 x 352

Pan/Tilt/Zoom

- Pan Range: -170° to 170°
- Tilt Range: -25° to 90°
- Digital Zoom: 10x¹
- Manual pan speed: 1-10
- Manual tilt speed: 1-10
- Pre-set setting: 10 points

Audio Compression

- ADPCM, PCM

Network Protocol Support

- Pv4, ARP, TCP, UDP, ICMP, DHCP Client, NTP Client (D-Link), DNS Client, DDNS Client (D-Link), SMTP Client, FTP Client, HTTP Server, PPPoE, RTP, RTSP, RTCP, 3GPP

Remote Management

- Configuration accessible via web browser
- Take snapshots/video clips and save to local hard drive via web browser

Remote Viewing Mobile Apps

- mydlink Lite - view and control mydlink cameras
- mydlink+ - tablet app with multi-camera view

Security

- Administrator and user group protected
- Password authentication
- HTTP and RTSP digest encryption

Surveillance

- Record video continuously
- Record video according to a weekly schedule
- Record video when motion or sound is detected

- Upload snapshots/video clips via e-mail
- Upload snapshots/video clips via FTP

Power Input

- 12V/1.25 A, 50/60 Hz

Power Consumption

- 10.5 watts maximum

Network Interface

- IEEE 802.11n
- 10/100 Ethernet

Dimensions (L x W x H)

- 4.46 x 4.46 x 4.92 inches (114 x 114 x 125 mm)

Weight

- 1.19 lb (540 grams)

Operation Temperature

- 32 to 104 °F (0 to 40 °C)

Storage Temperature

- -4 to 158 °F (-20 to 70 °C)

Humidity

- 20% to 80% non-condensing

Certifications

- FCC Class B
- CE
- CE LV D
- C-Tick

¹4x digital zoom enlarges an image by magnifying the pixels in a selected portion of the image by 4 times.

²The mobile device must have a mobile or WiFi data connection. Non-iOS/Android playback devices must be equipped with 3G video playback software such as RealPlayer™ or PacketVideo™.

³microSD and SIM not included.

⁴Zero Configuration requires a mydlink-enabled Cloud Router

⁵Use of audio or video equipment for recording the image or voice of a person without his/her knowledge is prohibited in certain countries or jurisdictions. D-Link disclaims any liability whatsoever for any end-user use of D-Link products which fails to comply with applicable laws and regulations.

⁶Using equal storage space, H.264 video compression records up to 5X more when compared to MJPEG recording.

⁷Maximum wireless signal rate derived from IEEE Standard 802.11 specifications



*mydlink Lite only

For more information

U.S.A. | 17595 Mt. Herrmann Street | Fountain Valley, CA 92708 | 800.326.1688 | dlink.com

Product specification, size, and shape are subject to change without notice, and actual product appearance may differ from that depicted on the package. See inside package for warranty details. This product is designed for use in the USA and Canada. Use of this product in other countries might violate local laws.

©2013 D-Link Corporation/D-Link Systems, Inc. All rights reserved. D-Link, the D-Link logo, the D-Link Green logo, the mydlink, Zero Configuration logo, RoHS logo are registered trademarks of D-Link Corporation or its subsidiaries in the United States and/or other countries. Other trademarks or registered trademarks are the property of their respective owners.

Updated 12/12/13

D-Link®
Building Networks for People