

DHP-601AV



**PowerLine AV2 1000 Gigabit Starter Kit
Quick Install Guide**

D-Link[®]

Package Contents



Two Powerline AV2 1000 Gigabit Adapters (DHP-600AV)



Two Ethernet Cables



Quick Install Guide

If any of the above items are missing, please contact your reseller.

Installation Considerations

1. Connect PowerLine devices into electrical outlets that are not controlled by a wall switch. This will help you to avoid accidentally turning off power to the device.
2. Do not connect your PowerLine devices to extension cords, surge protectors, or power strips. Doing this might prevent your devices from working correctly, or may reduce network performance.
3. Avoid plugging your PowerLine devices into electrical outlets that are located near appliances that use a lot of power, such as washers, dryers, and refrigerators. Doing this could prevent the adapter from working correctly, or may negatively impact network performance.
4. Verify that your PowerLine devices are electrically rated to operate with the power available in your location.
5. Be sure to plug the power cables into properly grounded electrical outlets in order to help prevent against electrical shock.

Product Overview

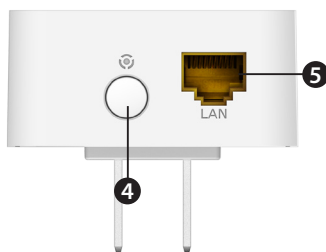

1	Power LED	<ul style="list-style-type: none">• Solid: The device is receiving electrical power.• Blinking: The device is powering up or in power saving mode. The light will also blink during the Simple Connect process.• Off: The device is not receiving electrical power.
2	PowerLine LED	<ul style="list-style-type: none">• Solid: The device is connected to a Powerline network.• Off: The device has not found any other compatible Powerline devices using the same encryption key. <p>The color indicates the Powerline link rate:</p> <ul style="list-style-type: none">• Green: The Powerline link rate is best.• Amber: The Powerline link rate is better.• Red: The Powerline link rate is good.
3	Ethernet LED	<ul style="list-style-type: none">• Solid: The Ethernet port is linked.• Off: There is no Ethernet connection.
4	Simple Connect Button/ Reset Button	Press and hold the button for two seconds to secure your network or hold the button for 10 seconds to reset to the factory default settings.
5	Gigabit Ethernet Port	Connect to a 10/100/1000 Ethernet device such as a router, computer, gaming console, network storage unit, or a media player.

Recommendations

- For best results, use in a regular wall outlet without any other devices plugged in. Plugging into a power strip or a surge protector may adversely affect the performance of this product.
- Avoid using the PowerLine adapters in an electrical outlet that is located near an appliance that uses a lot of power, such as a washer or dryer, refrigerator, microwave, hair dryer, or air conditioning unit.
- To verify connectivity or if you are having connection problems, plug the adapters in the same room to verify whether your home's electrical wiring is contributing to the issue. The adapters' PowerLine LED indicators will illuminate if the connection is established. Once configured you may place the adapter in the location of your choice.

Installation

- 1 Plug in one of the DHP-600AV adapters and connect to your router with an Ethernet cable. The Power and Ethernet LEDs should both light up.

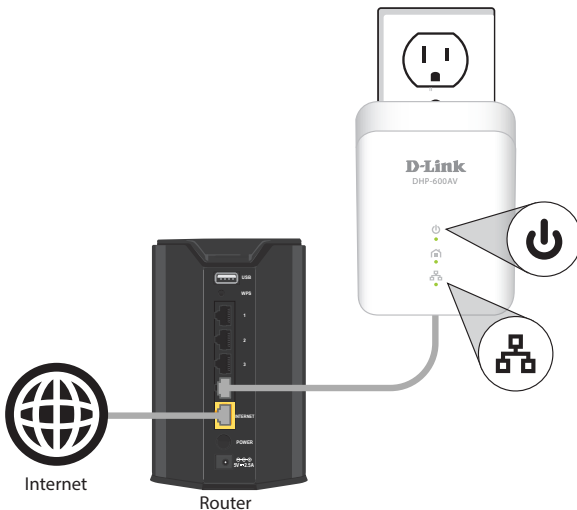

-
- 2** Plug in the other DHP-600AV adapter in the room that you want to extend your network. The Power LED will turn on. You can now connect a device such as a computer, game console, printer, or Smart TV using an Ethernet cable to the DHP-600AV adapter. Verify that the Ethernet LED is lit.



- 3** Verify that the PowerLine LEDs on both adapters are lit. If they are, the adapters are connected. If not, try another outlet.

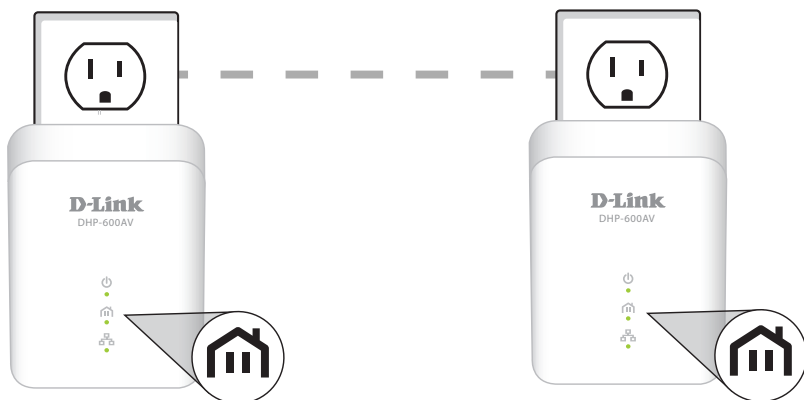

-
- 4** (Optional/Recommended) To secure your network, press the Simple Connect button (on the bottom) for two seconds on one of the adapters. The Power LED will start to blink. Then, within two minutes, press the Simple Connect button on the other adapter for two seconds. Once the Power LEDs stop blinking, verify that the PowerLine LED is lit on both adapters (as in Step 3). This indicates that your adapters are properly connected to each other.

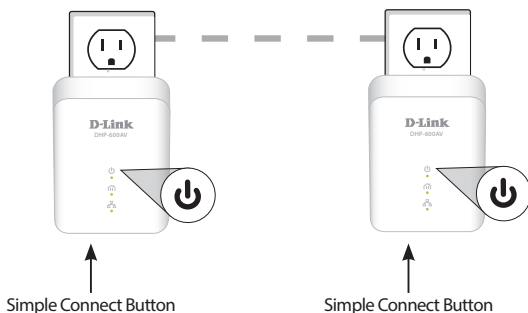

- 5** Your installation is completed.

FAQs

If I do not see LEDs light up?

If the Power LED is off, make sure the PowerLine devices are plugged into outlets with power. Also make sure the PowerLine devices are not plugged into an extension cord, power strip, or surge protector.

If the PowerLine LED is off, the devices are unable to find each other. You can plug in all the PowerLine adapters within the same room in order to determine whether your home's electrical outlets are suitable. The adapters' PowerLine LED will light up when a connection is established.

If I'm having problems with configuration?

If you are having problems configuring the network with two or more PowerLine adapters, make sure you reset all the devices and start the configuration process again.

If you get an error message during configuration, make sure you have not inadvertently unplugged the PowerLine adapter.

Technical Support

This guide is only for initial configuration. Please refer to the user manual to learn more or visit <http://www.mydlink.com> for more information. Also feel free to contact us. U.S. and Canadian customers can contact D-Link Technical Support through our website. For warranty and regulatory information, please visit <http://support.dlink.com/warranty.aspx>.

USA



<http://support.dlink.com>

Canada



<http://support.dlink.ca>

D-Link®

Version 3.00

May 20, 2016

Copyright ©2016 D-Link Corporation/D-Link Systems, Inc. All rights reserved. D-Link and the D-Link logo are registered trademarks of D-Link Corporation or its subsidiaries in the United States and other countries. Other trademarks are the property of their respective owners. Product specifications, size and shape are subject to change without notice, and actual product appearance may differ from that depicted on the packaging. Visit www.dlink.com for more details. Maximum throughput based on theoretical transmission PHY rate. Actual data throughput will vary. Network conditions and environmental factors, including volume of traffic and network overhead, may lower actual data throughput rate. Interference from devices that emit electrical noise, such as vacuum cleaners and hair dryers, may adversely affect the performance of this product. This product may interfere with devices such as lighting systems that have a dimmer switch, short wave radios, or other powerline devices that do not follow the HomePlug AV and IEEE1901 standard.
