



## **POWERLINE AV WIRELESS N STARTER KIT**

Extend your existing wireless network coverage over your electrical system

Up to 200Mbps through PowerLine for streaming HD video and lag-free gaming<sup>3</sup>

Easily connect and secure your network with push button security



### **INSTANT HOME NETWORKING**

The D-Link PowerLine AV Wireless N Starter Kit (DHP-W307AV) comes with one wireless extender (DHP-W306AV) and one adapter (DHP-306AV) and is compliant with the HomePlug AV standard to instantly transform your home's existing electrical wiring into a high-speed network<sup>2</sup>. Simply connect the PowerLine adapter to your router's ethernet port and plug it into a power outlet to turn every other power outlet in your home into a possible network connection. Then, plug the extender into an outlet in a different room to extend your existing wireless network to anywhere in your home. This kit enables you to extend your wireless network to the farthest corners of your home without the need for unsightly network cables. No extra drilling or extra wiring required.

### **FASTER WIRELESS SPEEDS, WIDER HOME COVERAGE**

The wireless extender uses 802.11n wireless technology with intelligent antennas to maximize the speed and range of your wireless signal to significantly outperform 802.11g devices<sup>1</sup>. The wireless extender is capable of delivering transfer rates up to 200Mbps<sup>3</sup> through PowerLine, so you can stream high definition video, enjoy lag-free gaming and faster access to large files within your network.

### **EASY SECURITY SET UP**

The D-Link PowerLine AV Wireless N Starter Kit (DHP-W307AV) features a Wi-Fi Protected Setup™ (WPS) button which can sync your PowerLine adapter to the same wireless setting as your existing Wireless Router or Access Point. Simply press the WPS button on your existing Router or Access Point and press WPS Push Button on the wireless extender to sync them up. In addition, the DHP-W307AV also features a Simple Connect Button that enables secure transmission between each HomePlug AV device.

### FEATURES

- Create a PowerLine Network right out of the box
- Uses your home's existing electrical wiring by plugging into existing power outlets<sup>2</sup>
- Speeds up to 200Mbps<sup>3</sup> for PowerLine network
- IEEE 802.11n and 802.11g Compliant
- Wi-Fi® Protected Setup™ (WPS) for simple Push-Button Wireless
- One touch AP configuration
- Power Saving Mode
- Push and Secure encryption button
- Supports Secure Wireless Encryption using WPA™ or WPA2™
- Supports 128-bit AES encryption for network security
- QoS Support Helps Prioritize Internet Traffic
- Plug & Play Installation
- 24/7 Basic Installation Support<sup>4</sup>
- 1-Year Limited Warranty<sup>5d</sup>

### THINK GREEN

D-Link Green™ devices are about providing eco-friendly alternatives without compromising performance. They are designed to help conserve energy, protect our environment from harmful substances, and reduce waste by using recyclable packaging. To learn more, visit [www.dlinkgreen.com](http://www.dlinkgreen.com).

### D-LINK GREEN™ TECHNOLOGY

- + Goes into power saving mode when no data link is detected after 5 minutes

### PROTECTING THE ENVIRONMENT

- + Complies with the European Union's RoH directive that restricts the use of certain hazardous materials
- + Uses soy ink and recyclable packaging to help reduce waste that goes into the environment



# HOMEPLUG AV

### NETWORK DIAGRAM

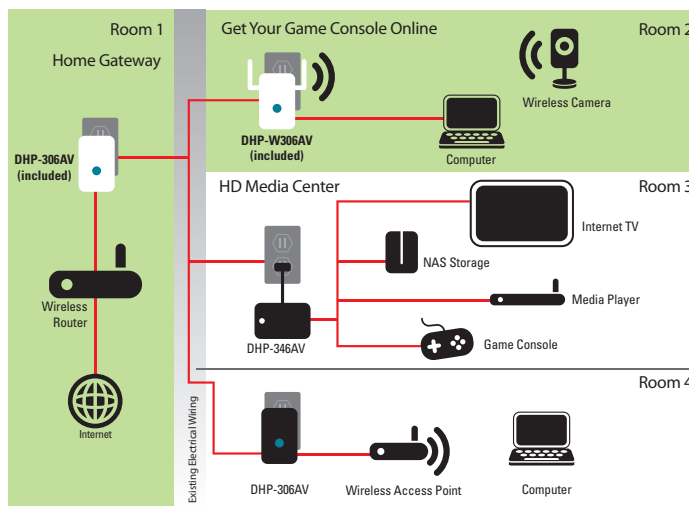

### TECHNICAL SPECIFICATIONS

#### STANDARDS

- + IEEE 802.3
- + IEEE 802.3u
- + IEEE 802.11b
- + IEEE 802.11g
- + IEEE 802.11n
- + HomePlug AV

#### ETHERNET INTERFACE

- + 10/100Base-TX Ethernet Port with Auto MDI/MDIX
- + RJ-45 Connector

#### MAXIMUM DATA RATE

- + PowerLine: Up to 200Mbps
- + Wirelss: Up to 300Mbps

#### ANTENNA

- + Two fixed external 2 dBi Omni-direction antennas

#### POWERLINE MODULATION SCHEME

- + OFDM Symbol Modulation

#### WIRELESS FREQUENCY RANGE

- + 2.4GHz ~ 2.497GHz

#### POWERLINE FREQUENCY BAND

- + 2Mhz to 30Mhz

#### SECURITY

- + 128-bit AES Data encryption
- + WEP 64/128-Bit Data encryption
- + Wi-Fi Protected Access (WPA/WPA2)
- + WPS™

#### LEDs

- + Power
- + Powerline
- + Ethernet
- + WLAN

#### POWER INPUT

- + 100~240V, 50/60Hz

#### POWER SAVING

- + Power saving mode supported
- + Compliant with European Energy using Product Directive (EuP)

#### SAFETY CERTIFICATION

- + UL
- + Wi-Fi

#### EMC CERTIFICATION

- + FCC
- + IC

#### OPERATING TEMPERATURE

- + 30°F to 104°F (0°C to 40°C)

#### OPERATING HUMIDITY

- + 10% to 95% (Non-condensing)

#### DIMENSIONS (L x W x H)

- + DHP-W306AV: 4.25" x 3" x 2.2"
- + DHP-306AV: 4" x 3" x 1.5"

#### WEIGHT

- + DHP-W306AV: 0.24lbs
- + DHP-306AV: 0.46lbs

#### WARRANTY

- + 1-Year Limited<sup>5</sup>

<sup>1</sup> Maximum wireless signal rate derived from IEEE Standard 802.11 specifications. Actual data throughput will vary. Network conditions and environmental factors, including volume of network traffic, building materials and construction, and network overhead, lower actual data throughput rate. Environmental factors will adversely affect wireless signal range. Wireless range and speed rates are D-Link RELATIVE performance measurements based on the wireless range and speed rates of a standard Wireless G product from D-Link. Maximum throughput based on D-Link's 802.11n devices.

<sup>2</sup> Power outlets and electrical wiring must all be part of the same electrical system. Certain electrical conditions in your home, such as wiring conditions and configuration may affect the performance of this product. A minimum of two D-Link PowerLine AV Network Adapters are required to create a network. Connecting this product to a power strip with a surge protector may adversely affect the performance of this product. For best results, plug adapter directly into a power outlet.

<sup>3</sup> Maximum throughput based on theoretical transmission PHY rate. Actual data throughput will vary. Network conditions and environmental factors, including volume of traffic and network overhead, may lower actual data throughput rate. Interference from devices that emit electrical noise, such as vacuum cleaners and hair dryers, may adversely affect the performance of this product. This product may interfere with devices such as lighting systems that have a dimmer switch, short wave radios, or other powerline devices that do not follow the HomePlug Powerline Alliance standard.

<sup>4</sup> 24/7 Basic Installation Support is available only in the USA for the first 30 days from date of original purchase.

<sup>5</sup> 1-Year Limited Warranty available only in the USA and Canada.

<sup>6</sup> Computer must adhere to Microsoft's recommended system requirements.

<sup>7</sup> Software included is not Mac-compatible.

<sup>8</sup> Latest Software and Documentation available at <http://support.dlink.com>

Product specification, size, and shape are subject to change without notice, and actual product appearance may differ from that depicted on the package. See inside package for warranty details. D-Link PowerLine AV Network Adapters (DHP-W306AV, DHP-306, DHP-307AV, DHP-346AV, DHP-310AV, DHP-311AV, DHP-347AV, DHP-348AV, DHP-500AV, DHP-501AV, DHP-540AV, and DHP-541AV) may coexist with but are not compatible or interoperable with D-Link PowerLine HD Ethernet Adapters (DHP-302, DHP-303). This product is designed for use in the USA and Canada. Use of this product in other countries might violate local laws.

©2011 D-Link Corporation/D-Link Systems, Inc. All rights reserved. D-Link, the D-Link logo, the D-Link Green logo, and the D-Link RoHS logo are registered trademarks of D-Link Corporation or its subsidiaries in the United States and/or other countries. Other trademarks or registered trademarks are the property of their respective owners.

#### PACKAGE CONTENTS

- + 1 PowerLine AV Wireless N Extender (DHP-W306AV)
- + 1 PowerLine AV Network Adapter (DHP-306AV)
- + 2 Ethernet Cable
- + CD-ROM® with:
  - PowerLine AV Utility
  - Product Documentation

#### MINIMUM REQUIREMENTS

- + Windows® 7®, Windows Vista® or Windows® XP SP3®
- For Configuration Utility, Computer with:
  - + 233MHz Processor
  - + 10MB Disk Space
  - + 64MB RAM
  - + CD-ROM Drive
  - + Network Interface Card

#### Power Supply:

- + 110~240VAC, 50/60Hz
- For Internet Access:
  - + Cable or DSL Modem
  - + Router
  - + Subscription with an Internet Service Provider (ISP)
- For Network:
  - + Two or more PowerLine AV Devices