



Dual Band Whole Home Wi-Fi System

# Simple Setup Guide

There are two easy ways to set up your Covr Wi-Fi System



- 1 **D-Link Wi-Fi App Setup**  
Download the D-Link Wi-Fi app from the App Store or Google Play.



- 2 Open the app and tap **Install New Device**. Next, either scan the QR code in the Quick Install Card, or select **COVR-C1203** from the list and follow the on-screen instructions to complete the setup.

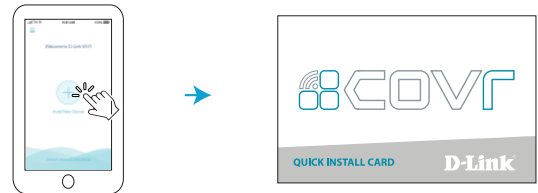

OR

- 1 **Web Browser Setup**  
Connect the power adapter and plug in the Covr Point labeled **A**.

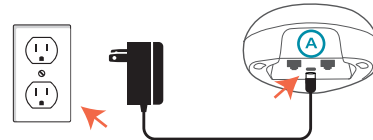

- 2 When the Covr LED is blinking amber, connect your PC or laptop to the Wi-Fi name (SSID) printed on the back of the device, or on the included Quick Install Card.



- 3 Type **http://covr.local/** into a web browser and follow the on-screen instructions to complete the setup.

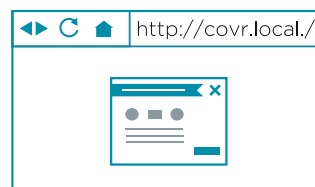

## Covr Point Placement Guideline

Place your Covr Points around your home to extend your whole home Wi-Fi.

Check the LED indicator on your Covr Points to ensure proper connection.

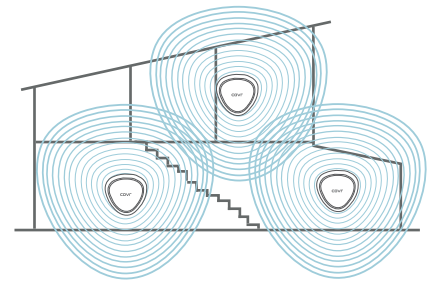

Solid white: Strong signal.



Blinking white: Weak signal. Move your Covr Point closer to the Covr Point labeled **A** until the LED turns solid white.



Blinking orange: No signal. Move your Covr Point closer to the Covr Point labeled **A** until the LED turns solid white.

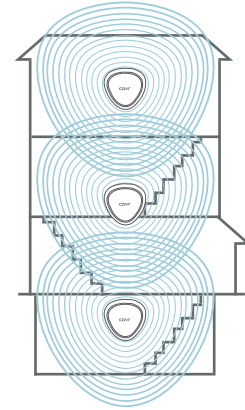

Cover Plate - You can change the cover plate to the color of your choice

1

### Changing the Covr Plate

Press the button on the back firmly until the cover plate pops off. Do not try to pry it off.

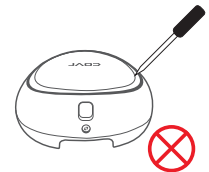

2

Place the replacement plate on the device, aligning the guide pins on the plate with the holes in the Covr Point. Press down and then slide it towards the button to lock it in place.

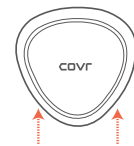
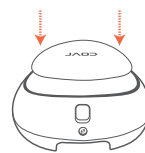

## Technical Support

Having trouble installing your new product? D-Link's website contains the latest user documentation and software updates for D-Link products. You can also contact D-Link Technical Support through our website, or phone number below.

United States  
Internet: <http://support.dlink.com>  
Phone: 877-453-5465