

1. Turn Off Circuit Breaker

Turn off the power to the light switch at the main circuit breaker or fuse box.

Important: Flip your light switch a few times to ensure the power is off.

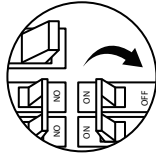

2. Remove Faceplate from Old Switch

Take a picture for future reference

1- Gang

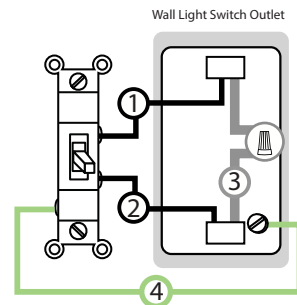

2- Gang

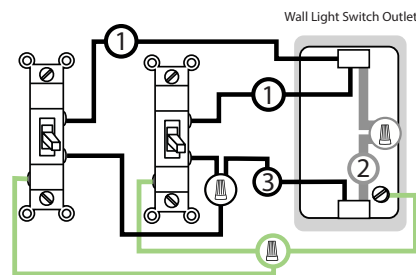

- 1 Load Required. You need 1 load for 1-gang.
- 2 Hot Wire (Live) Required.
- 3 Neutral Required, but not always present. **STOP if you do not have it.**
- 4 Ground Optional, and not always present.

- 1 Load Required. You need 2 loads for 2-gang.
- 2 Neutral Required, but not always present. **STOP if you do not have it.**
- 3 Hot Wire (Live) Required.
- 4 Ground Optional, and not always present.

3. Wire Labeling

Use the included wiring labels and attach the stickers to the corresponding wires. Green for "Ground", white for "Neutral", black for "Hot", red for "Upper Light" and brown for "Lower Light".

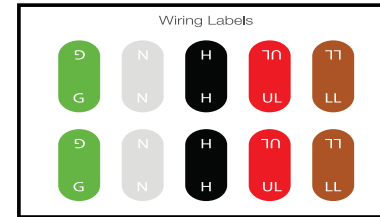

4. Remove Old Switch

Disconnect the old switch from the electrical box.

5. Wiring

Connect the wires from the Komfy Switch to the old switch wires.

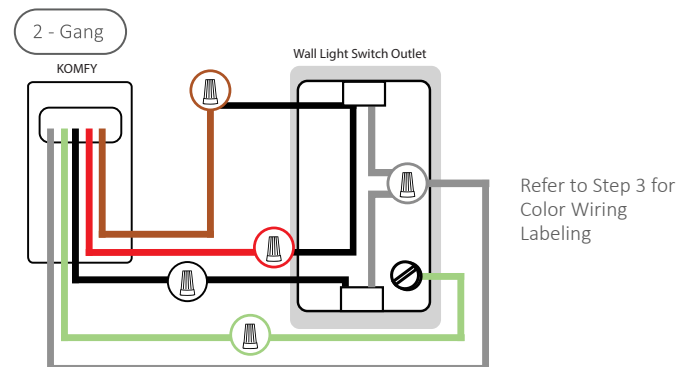
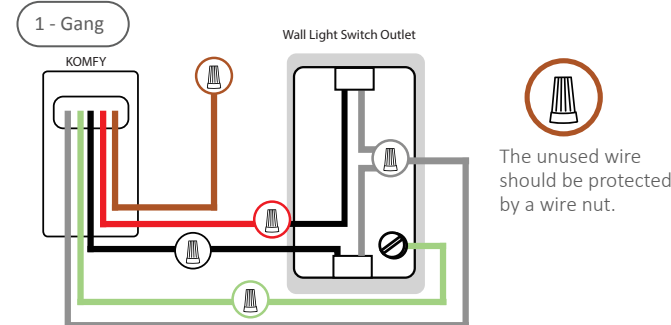

6. Attach Komfy Switch

Screw the Komfy Switch into the electrical box and then slide the power selector to 1 or 2. 1-gang and 2-gang have different screws patterns as shown below:

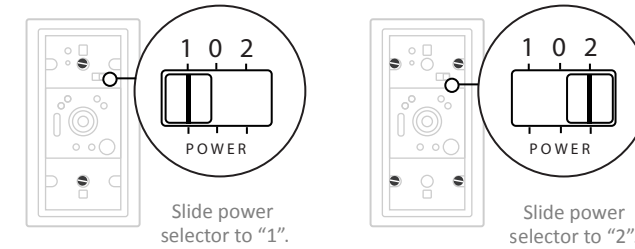

1 - Gang:
2 middle screws

2 - Gang:
4 side screws

7. Turn On The Circuit Breaker

Turn the power back on at the circuit breaker or fuse box.

8. Press and Hold Setup Button for 5 Seconds

When the Wi-Fi LED lights up, press and hold the setup button for 5 seconds until the Wi-Fi LED starts blinking. When the Wi-Fi LED stops blinking, the Komfy Switch is ready to be configured.

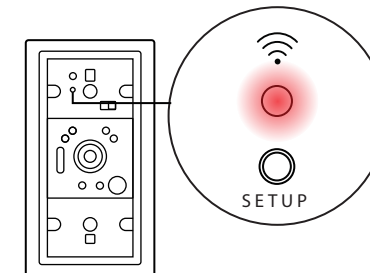

9. Attach Accessories

Attach the included faceplate to the Komfy Switch and then put the Komfy Switch cover with click pads over the faceplate.

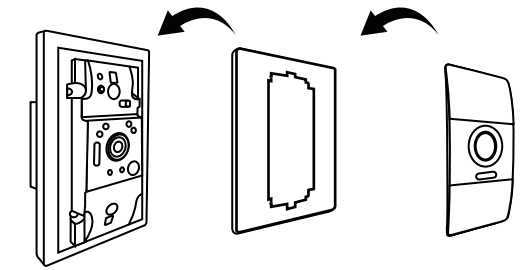

Komfy Switch

Faceplate

Komfy Switch Cover
With Click Pads

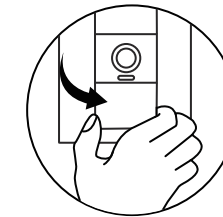

If you want to remove the the switch cover, pull out at the corners either at the top or bottom to remove it.

10. Configure Komfy Switch

Download the Komfy App and sign up for a Komfy account. Tap the "Add Device" button to complete the configuration.

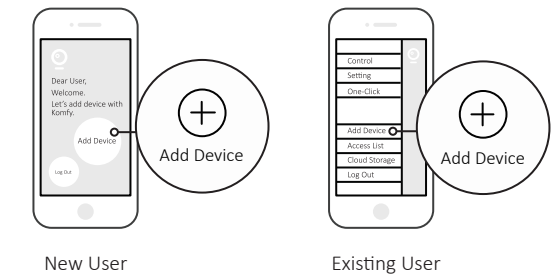

New User

Existing User

Contents

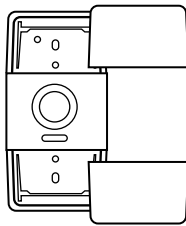

Komfy Switch Cover
with 2 Click Pads

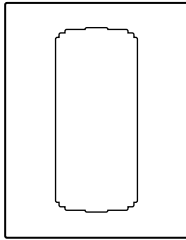

Faceplate

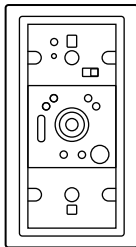

Komfy Switch

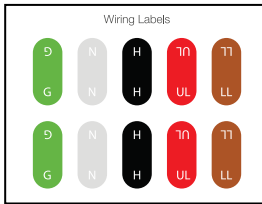

Wiring Labels

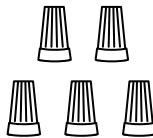

5 Wire Nuts

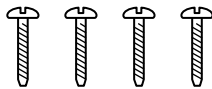

4 Screws



Quick Installation Guide Komfy Switch



WARNING! Potential Shock Hazard

Please read all the instructions before you begin installation. The Komfy Switch is designed for installation in standard electrical boxes and to be installed in accordance with National Fire Protection Association (NFPA 70). If you are not sure about any part of the instructions, consult a qualified electrician to perform the installation.

Verify Switch Compatibility

- 1. Not compatible with 3-way (multi-location control) switches.
- 2. Requires neutral wire (refer to Step 2).

Verify Wi-Fi Signal Strength

Hold your iPhone close to the switch you are replacing. Make sure you have a good Wi-Fi signal there.